

Semi Trailer Converted To Big Capacity Grain Hauler

"We use my home-built, tandem axle grain wagon to haul corn from the field to our grain dryer. I built it several years ago out of an old semi trailer, at a cost of less than \$3,000," says William Davis, Masontown, W. Va.

The wagon holds about 500 bu. of corn and is equipped with a rear-unloading auger at the bottom. It weighs about 9,000 lbs. empty and almost 40,000 lbs. when fully loaded. Davis pulls it behind an IH 2 plus 2 tractor with 170 hp.

The wagon's running gear, tandem axles, and air brakes came off the semi trailer. He used 10-in. channel iron to build a frame that attaches to the tandem axles. He used 4 by 8 sheets of 14-ga. steel and 3 and 4-in. channel iron to build the box, which is supported by

4-in. vertical "ribs". Channel iron was also used for the tongue. A homemade cable and pulley system, connected to a hydraulic cylinder, is used to activate the brakes.

Davis used a length of 6-in. dia. well casing to house the unload auger, which operates off tractor hydraulics. "I cut a series of 12-in. wide slots about 1 ft. apart into the casing and covered them with sliding metal doors, which I can manually open or close by turning a screw on back of the wagon. Makes it easy to control the flow of grain," says Davis.

Contact: FARM SHOW Followup, William Davis, 1250 Long Hollow Road, Masontown, W. Va. 26542 (ph 304 435-9622; carolynbuchman@gmail.com).



William Davis used the running gear from an old tandem axle semi trailer to build this 500-bu. rear-unloading grain hauler.

Push Mower Fitted With Built-In Trimmer

While wandering through the recent Green Industry and Equipment (GIE) show in Louisville, Ky., we spotted this prototype mower fitted with a trimmer attachment that doubles as an edger.

When you hit a patch of weeds against a building or fence, just press a button on the patented Mow & Row's control panel on the mower handle to activate the weedeater. It attaches to the end of a long hinged shaft, which emerges horizontally from an opening on front of the deck and then folds down to a horizontal position.

Press another button on the handle and the

trimming orientation changes from horizontal to vertical, converting the weedeater into an edger.

Once the area is cut, just press a button again and the weedeater retracts back into the deck. The control panel can also be used to adjust the trimmer's speed.

Inventor Jimmy Bernard says he hopes to license the Mow & Row to a company soon.

Contact: FARM SHOW Followup, Jimmy Bernard, Fort Worth, Texas (ph 817 301-5479; j.f.bernard@hotmail.com; www.mowandrow.com).



Trimmer attaches to a long hinged shaft. When activated it emerges from an opening on front of deck and folds down to a horizontal position.

Tree Brace Sets Up Fast

"Our new Tree Hugger Brace kit lets one person stake a tree in only about 5 min. without using specialized tools. It can be easily removed and reused," says Farrell Gerber, Tree Hugger Solutions, Weston, Fla.

The kit comes with 3 tree brace support holders, 2 quick-adjust metal bands with screw-type clamps, and 3 protective cushion squares. The support holders come with slots designed to accept 2 by 4's, and are strapped to the tree with the metal bands.

You place the cushion square on the back side of each support holder using double sided tape (included) and then insert the 2 by 4 into the slot. All the support holders should be attached at the same height on the tree trunk. Then insert the metal bands through the slots and around the trunk. For added support, you can insert a pair of screws through pre-drilled holes near the bottom of

the support holder.

"The Tree Hugger is available in both fixed and adjustable models," says Gerber. "The slot on the adjustable model has a built-in articulated joint, which lets you change the angle of the 2 by 4 anywhere from 20 to 120 degrees just by lifting the board up or down. Makes it easy to compensate for any obstacles and for non vertical trunks."

The fixed model Tree Hugger sells for \$69.95; the adjustable model sells for \$79.95, which includes ground freight within the contiguous U.S.

Contact: FARM SHOW Followup, Tree Hugger Solutions, LLC, 2900 Glades Circle, Suite 700, Weston, Fla. 33327 (ph 954 719-8733; sales@treehuggerusa.com; www.treebrace.com).



Tree Hugger Brace kit is available in both fixed (left) and adjustable models.

"Snirt Stopper" Seals Up Garage Doors Tight

The idea for the "Snirt Stopper" originated in Kosovo when its inventor, Montie Beyer, was deployed there and worked with Kevlar, a tough yet pliable material. After returning home to Minnesota, he found a cross-mesh material used for semi tarps that had traits similar to Kevlar. He decided it would be perfect to tightly seal up leaky garage doors.

"Concrete in winter always moves. On my 16-ft. door, the concrete crowned really bad in the middle and the door faced north so I had snowdrifts inside. This seal adjusts to the gap throughout the winter without freezing to the floor," Beyer says. "It works on everything from walk-in doors to rollup, hydraulic, bifold and hangar doors."

Installation is easy - just secure self-tapping screws every 6 in. at the bottom of the door (inside). The bottom flap, which is backed by a 1 1/4-in. closed cell foam backer rod, floats on the floor.

"We use a closed cell foam used for

concrete in the ground so it doesn't shrink, deteriorate or expand," Beyer says. To accommodate big hangar and bifold doors, he makes Snirt Stopper with four sizes of foam ranging from 1 1/4 to 3-in. dia.

"About 80 percent of sales are ag related," Beyer says.

The business manufactures 150-ft. rolls of the seal in Osage, Minn., to be cut at any length at \$6.95/ft. They also make a seal for the sides of doors for \$4.95/ft.

"On a heated building, the bottom and side seals will pay for themselves in energy savings within the first year," he says.

At the recent Big Iron Farm Show in Fargo, sales were phenomenal, he says, and workers stayed busy cutting seals for farmers.

Snirt Stopper also works to keep out dust, bugs and rodents because the material is infused with a rodent-deterrent scent.

Finally, the door seal has a long life expectancy, 25-30 years on the side seal and

The Snirt Stopper

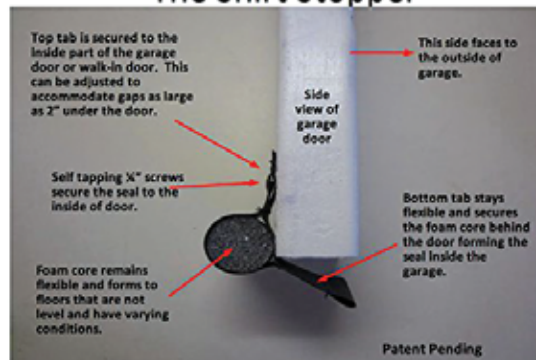

Snirt Stopper seal mounts on the inside face of the garage door, and can be adjusted to accommodate gaps as large as 2 in. under the door.

40-50 years on the bottom seal.

Check out the Snirt Stopper website for videos of how to install it and find dealers in your area.

"We are a veteran-owned company and give veterans a discount," Beyer notes.

Contact: FARM SHOW Followup, Montie Beyer, Snirt Stopper, High Plains Industries, LLC, 53351 State Hwy. 34, Osage, Minn. 56570 (ph 701 809-8133; www.snirtstopper.com).