

Decoupler Eliminates PTO Frustration

Detaching a coupler from a tractor pto or other combine drive can be anything but easy unless you have a decoupler like Jim Mueller.

"There've been times that I didn't know how I was going to get a coupler off," says Mueller. "Combine couplers gave me the worst trouble. I didn't want to beat on them for fear of damage."

Eventually, he came up with his decoupler. It consists of a U-shaped lever and a flange. The flange is bolted between the lever ends and a few inches from the ends. Self-locking nuts hold the flange loosely in place while allowing it to pivot. Tabs on the shaft edges of the flange catch the front edge of the coupler.

"I fit the flange over the pto shaft and pull the lever toward me," says Mueller. "The flange tabs push the coupler off the shaft as the lever ends press against the combine shaft or tractor pto base. It took some finagling at first to get it right."

He notes that his design can be easily adapted to any style of shaft and removable coupler simply by replacing the flange that's bolted to the lever.

"There are many different styles and sizes of couplers, so I have different flanges for my different couplers," he says. "They also have different leverage points, and some require a block of wood to get the needed leverage."

Mueller had considered getting a patent on the decoupler but decided against it. "Patents are costly, and then I'd have to figure out shipping and handling," he says. "I decided it wasn't worth it. Now anyone can build their own."

Contact: FARM SHOW Followup, Jim Mueller, 1591 320th St., Hiawatha, Kan. 66434.



Decoupler flange tabs in place against coupler end.



Calving Assist belt fits around the glutes, taking the strain off the lower back and shoulders. It takes advantage of body weight and leg power during the pulling process.

Calving Belt Protects Farmers And Cows

Assisting a calving cow can be hard on the animal and the worker's back. Irish dairy farmer Jim Ryan invented a belt and harness system that he could wear to make the procedure safer for all involved.

"I came up with the Calving Assist after I realized I'd lost power in my lower back," says Ryan. "Sometimes, you just don't have a choice but to help pull a calf when cows go down against a wall or in tight quarters."

The Calving Assist belt fits around the glutes, taking the strain off the lower back and shoulders. It takes advantage of body weight and leg power during the pulling process. Chains or ropes are attached to two metal grapples to securely hold the calf along with the harness.

FRS Direct, an Irish agricultural equipment supplier markets the device.

Gerard Browne, FRS Direct online marketing executive, explains the safety feature of the belt. "When the animal can't be restrained and moves off quickly, one of the stainless-steel handles has a lever for a quick release, disconnecting the harness away from the animal to prevent any injury."



Belt has a quick release disconnect for animal safety.

Browne says the Calving Assist doesn't currently have dealers in the U.S., but the belt system can be ordered at a rough cost of \$150 USD for overseas delivery.

Contact: FARM SHOW Followup, FRS Direct, Carrigeen Industrial Estate, Barrack St. Cahir Co., Tipperary, Ireland E21 XN44 (ph 052 7441598; shop@frsdirect.ie; www.frsdirect.ie).

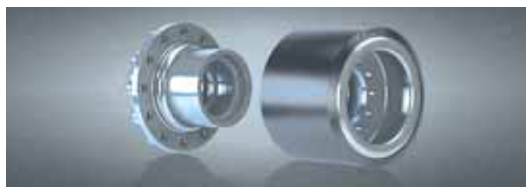

"After the initial installation of the Camso manufactured hub, a midroller can be replaced in under 15 min.," says Dalphond.

Midroller Conversion Kit Saves Time and Money

Owners appreciate the pulling power, low compaction, and other benefits of their STX Quadtrac tractors. With a total of 24 mid-rollers, maintenance can be time-consuming and costly. A 2-piece conversion kit from Camso reduces the labor and cost of future midroller replacements.

"It's best suited for demanding applications where midrollers are damaged and frequently replaced," says Jake Dalphond, AG track and wheels product line manager for Camso. "After the initial installation of the Camso manufactured hub, a midroller can be replaced in under 15 min."

Seals and bearings are exposed and are typically replaced when the OEM wheel/hub is removed. That's also necessary when the Camso midroller kit is first installed. But because it has a hub, only the midroller needs to be changed after that.

"That cuts down on maintenance costs," Dalphond says. "The wheel simply bolts onto the hub with 12 bolts."

The conversion kit with the integrated hub and midroller is less than \$800, and the replacement midroller is less than \$600.

Camso's 2-piece conversion kit works on STX Quadtrac tractors manufactured between 2006-2020 (after serial number JEE107427). They're available worldwide. Contact your local dealer or visit the Camso website for more information.

Camso is the world's biggest agriculture track business, with its main manufacturing plants in Kansas.

Contact: FARM SHOW Followup, Camso, Magog, Quebec (ph 844-226-7624; ag.productsupport@camso.co; www.camso.co).



Grain inspection is easier because of more removable and cleanable windows. A large opening makes it easier to capture samples of cleaned grain.

New Features Improve Grain Cleaner Performance

Two KDC grain cleaners from Kongskilde have new features for easier maintenance and improved operation. R & D manager Steen Hansen says the KDC PLUS series has easier opening side panels that allow quicker screen changes. Grain inspection is easier because of more removable and cleanable windows. A large opening makes it easier to capture samples of cleaned grain.

Hansen says the 4000 and 8000 PLUS models have the same exceptional cleaning functionalities as previous models. Those include dual cleaners with screen and aspirator functions. The two-stage screens sort grain by size, with the aspirator removing dust and light foreign matter.

Both models are ideal for pre-cleaning corn, barley, rye, peas, and beans, with

specific screens available for each crop. The cleaners can also grade malting barley and seed. Accessories include a rain cover for motors and gearboxes and a pipe system/cyclone that connects to the aspirator blower outlet for removing trash and fines. A transport kit is available for short-distance moves.

Hansen says both models have exceptional durability because all exposed components are made of galvanized steel. He adds that the most recent changes were made with the input and collaboration of many satisfied customers because KDC wants to sustain the popularity of their dual cleaner models.

Contact: FARM SHOW Followup, Kongskilde (mail@kongskilde-industries.com).



I WANT YOU

SHARE WHAT YOU KNOW

with other FARM SHOW Magazine readers!

We're Looking For Made-It-Myself Ideas, Creative Solutions To Common Problems, Best and Worst Buys, Maintenance Repairs, and Shop Tips!

TEXT: 952-465-5019

EMAIL: editor@farmshow.com

WRITE: FARM SHOW Magazine, PO Box 1029, Lakeville, MN 55044